



All prices are list prices for local market, for a quotation please contact us.

Price list

DN/type	KKC	VEF	DN/type	SF-S
100	10	6	100	16
125	12	7	125	19
150	13	7	160	24
200	18	12	200	34

Delivery: in stock

VEF overall dimensions

DN	A	B	C	F
100	100	70	145	55
150	150	115	195	55
200	200	172	240	55

KKC overall dimensions

DN	A	B	C	F
100	138	75	40	97.5
150	202	119	50	147.5
200	248	157	63	197.5

SF-S overall dimensions

DN	ØD [mm]	Ød [mm]	A [mm]
100	135	100	15
160	191	160	15
200	238	200	18

Description

- KKC:** ventilation valves with adjustable disc and fastening collar
 - made of aluminium with RAL 9010 finish
- VEF:** ventilation valves with adjustable disc and fastening collar
 - made of PVC, white
- SF-S:** adjustable ventilation valves, suitable for air supply and return, including acoustic insert
 - made of aluminium with RAL 9010 finish

Special versions

- made of 304/316 stainless steel (on request)
- VR: coating according to the RAL table (on request)

VEF

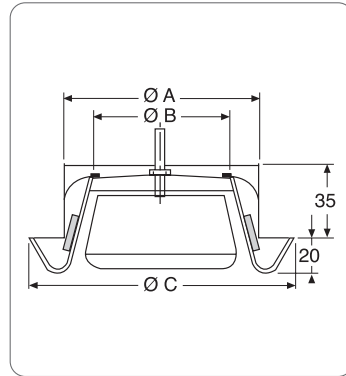

KKC

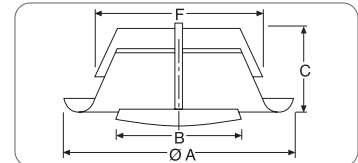

SF-S

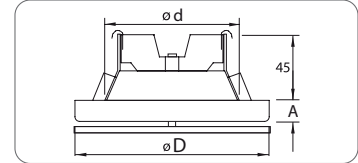

KKC / VEF selection diagrams
DN 100

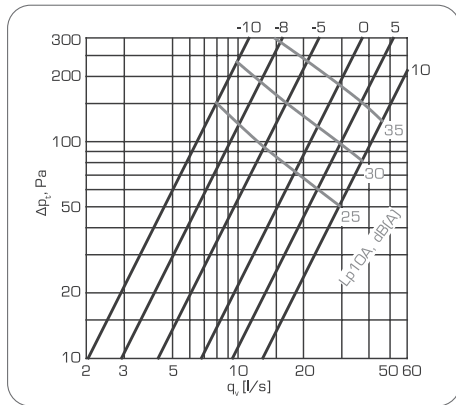

DN 150

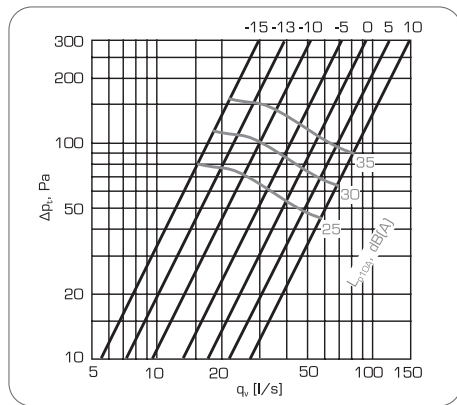

DN 200

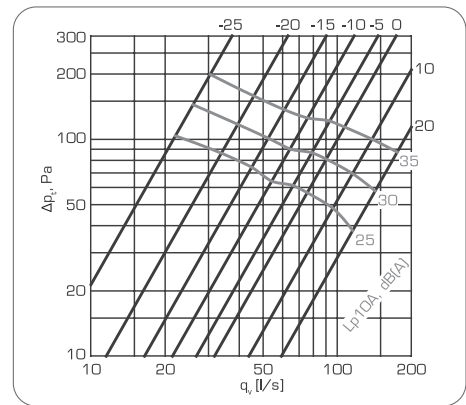

SF-S selection diagrams
DN 100

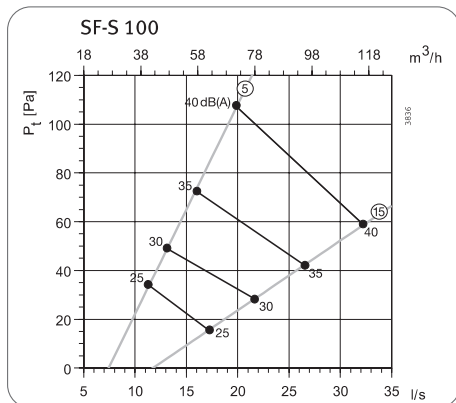

DN 160

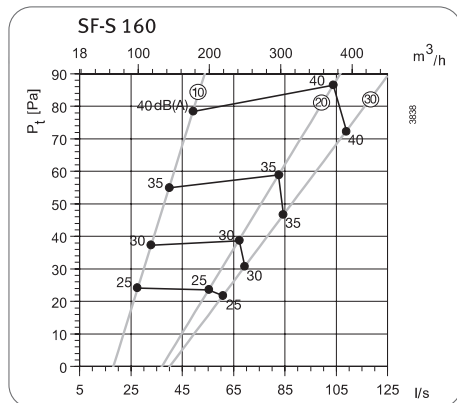

DN 200

